

EGLO

Art.-Nr.:31958

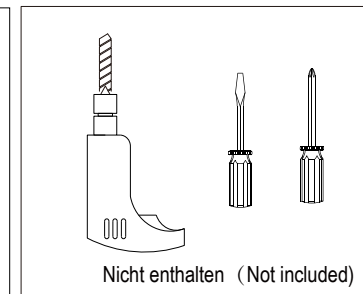

A

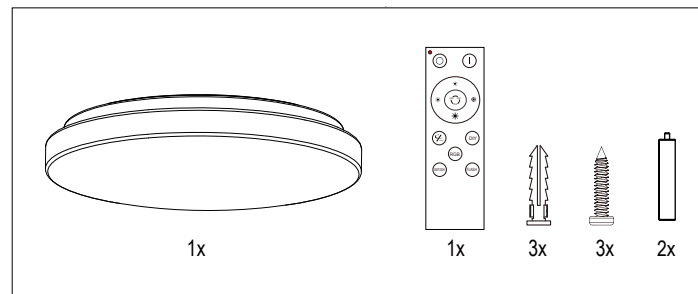
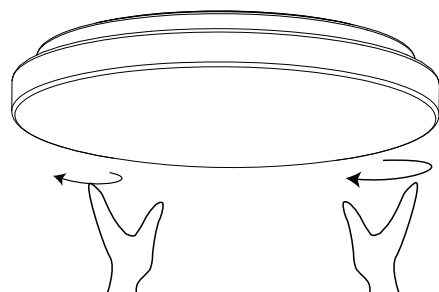

B

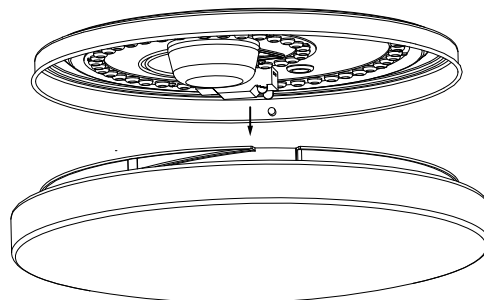

C

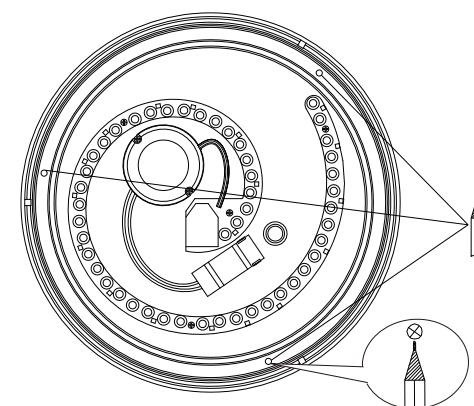

D

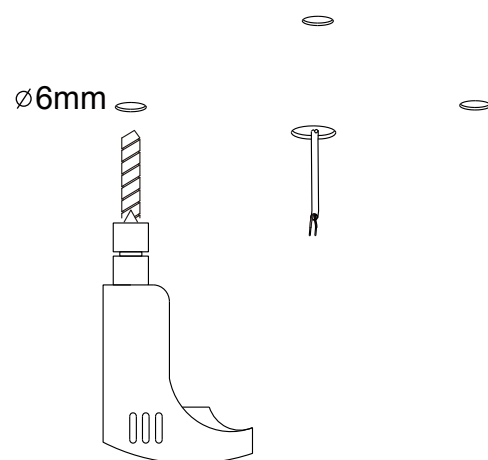

E

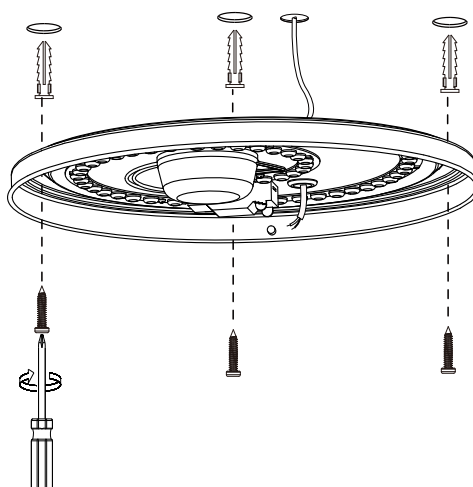

F

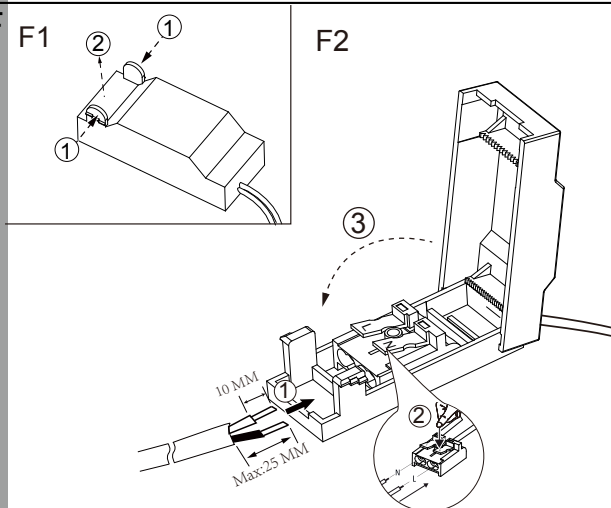

G

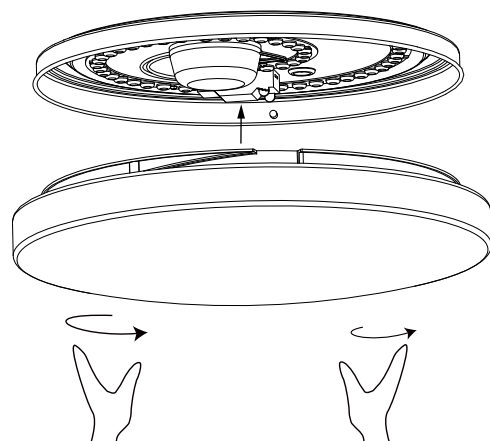

H

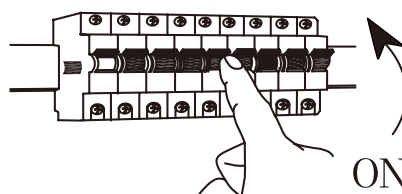

I

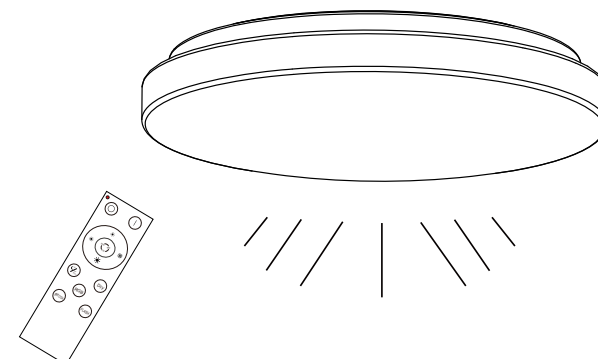

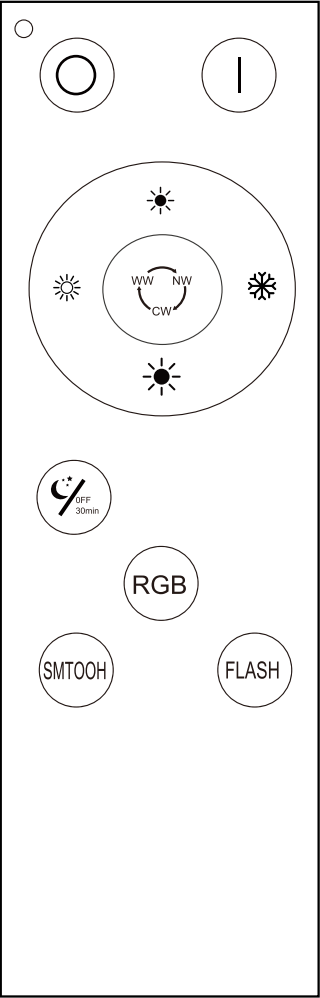

Function				Function description
1		Turn on the lights and restore the state before turning off the lights	Short press	Press the ON key to turn on the light when the lamp is off.
2		Turn off the lights and store all states	Short press	Press the OFF key to turn off the light when the lamp is on.
3	R	Red light	Long press	Stepless color adjustment, long press and hold to convert to red light.
4	B	Blue light	Long press	Stepless color adjustment, long press and hold to convert to blue light.
5	G	Green light	Long press	Stepless color adjustment, long press and hold to convert to green light.
6	CW	White light color temperature switching	Long press	White light minimum to maximum color temperature stepless cycle adjustment.
7		Brightness Plus	Long press	Stepless brightness adjustment plus until the highest brightness state is 100%
8		Brightness reduction	Long press	Stepless brightness adjustment reduction until the minimum brightness state is 5%
9		Night light/delayed light off	Short press/long press	1. Short press: night light 3000K, 10% brightness. In night light mode, press any other key to exit the night light function. 2. Long press: The light flashes three times and automatically shuts down after 30 minutes. In delayed light off mode, press any other key to exit the delayed light off function.
10		Color temperature switching	Short press	Short press: WW: 3000K NW: 4000K CW: 6500K cyclic switching; Long press: Invalid
11		Dynamic mode	Short press	RGB dynamic function, press other keys to exit
12		DIY	Long press/short press	After the lamp status is adjusted, press and hold for 2 seconds to store the final status (the lamp flashes once to indicate successful storage). Next time click one time to bring up the functional status of all lamps.

