

MEUBLE SOUS ÉVIER • 2 PORTES

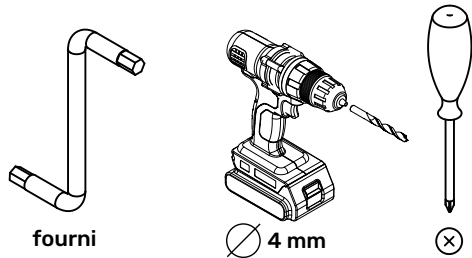

MATÉRIEL NECESSAIRE

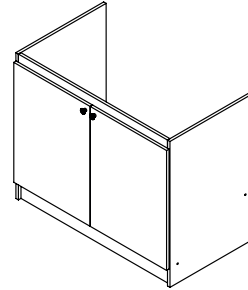

Un montage mal réalisé peut provoquer la chute du meuble.

Pour assurer une rigidité optimale, pensez à fixer le meuble au mur à l'aide d'une visserie adaptée (non fournie).

i

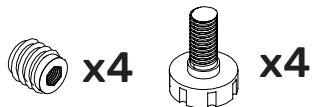

1

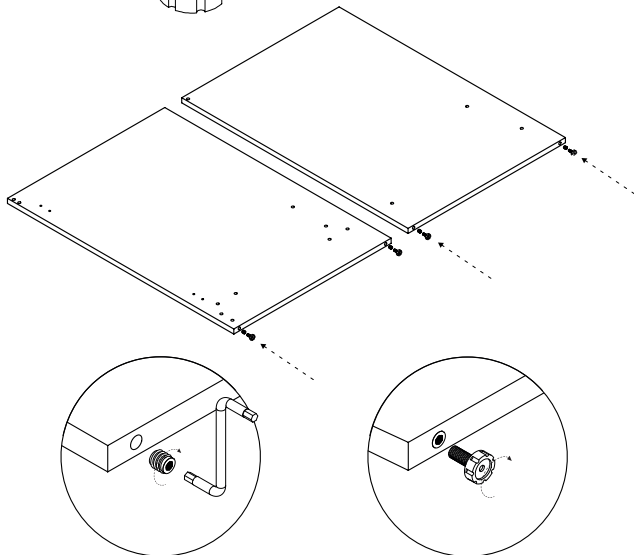

2

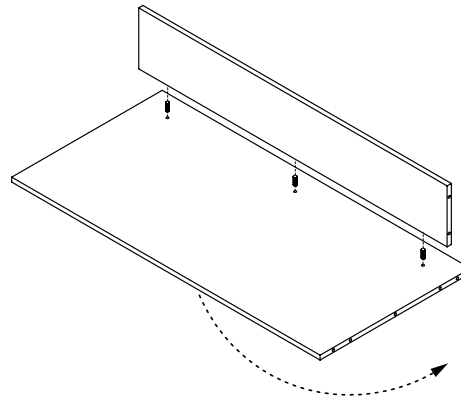

3

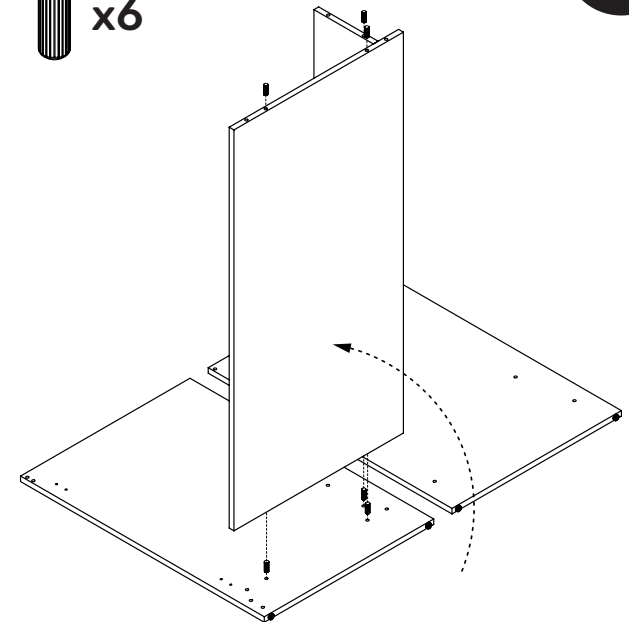

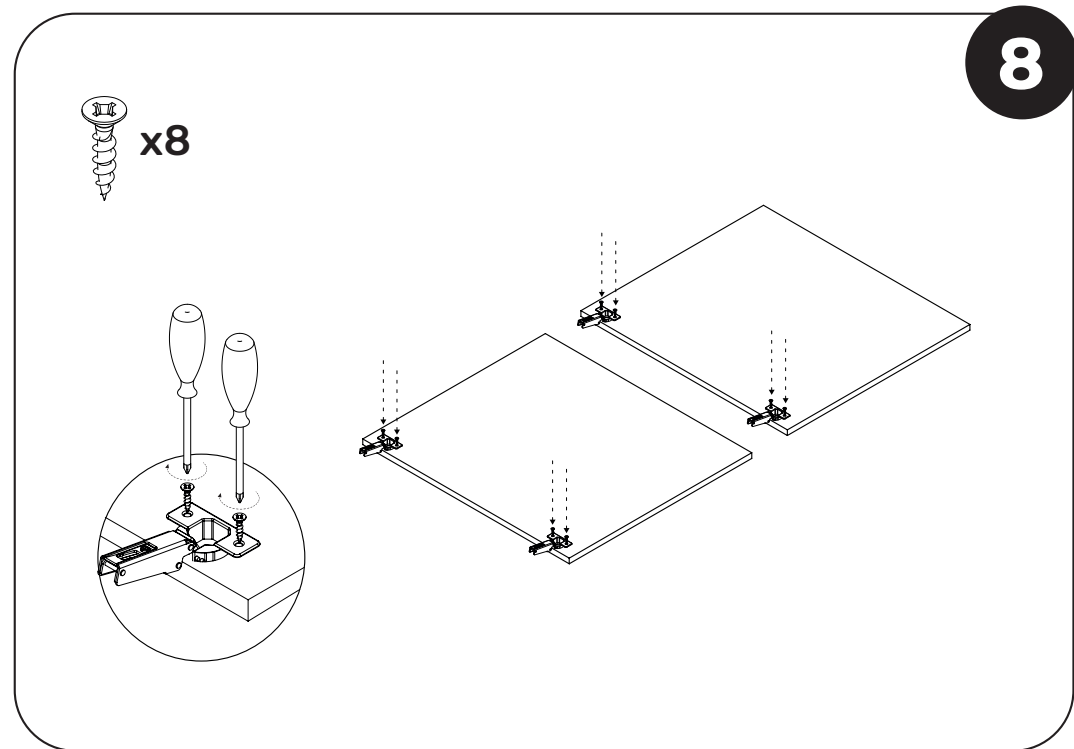
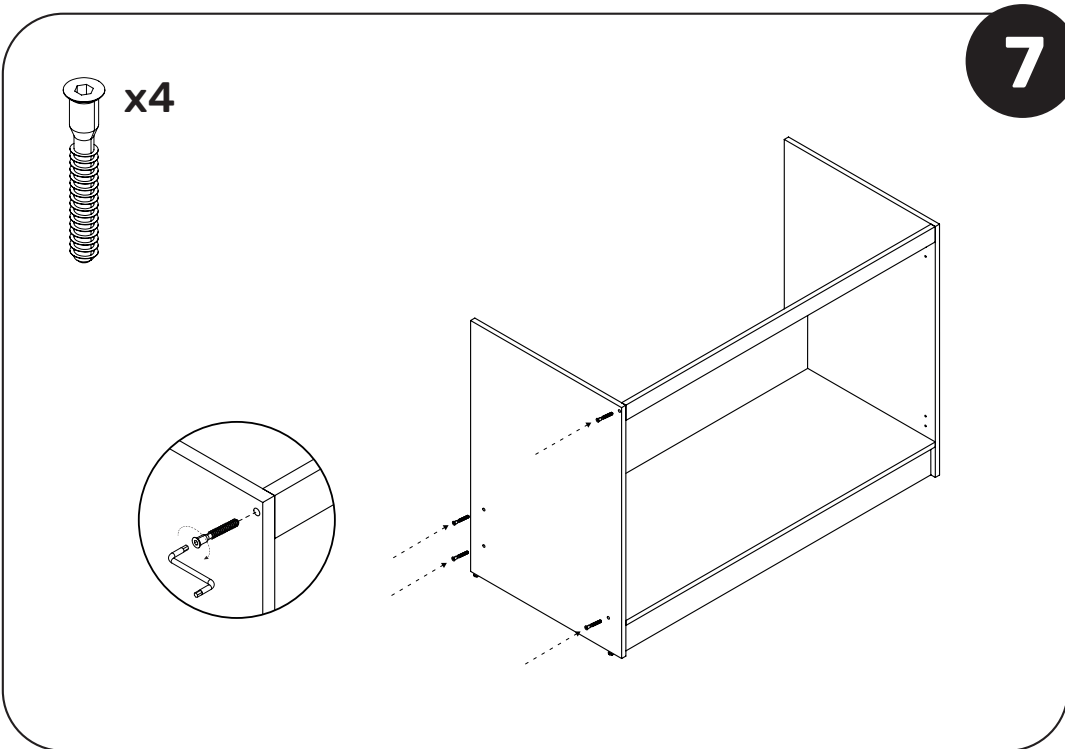
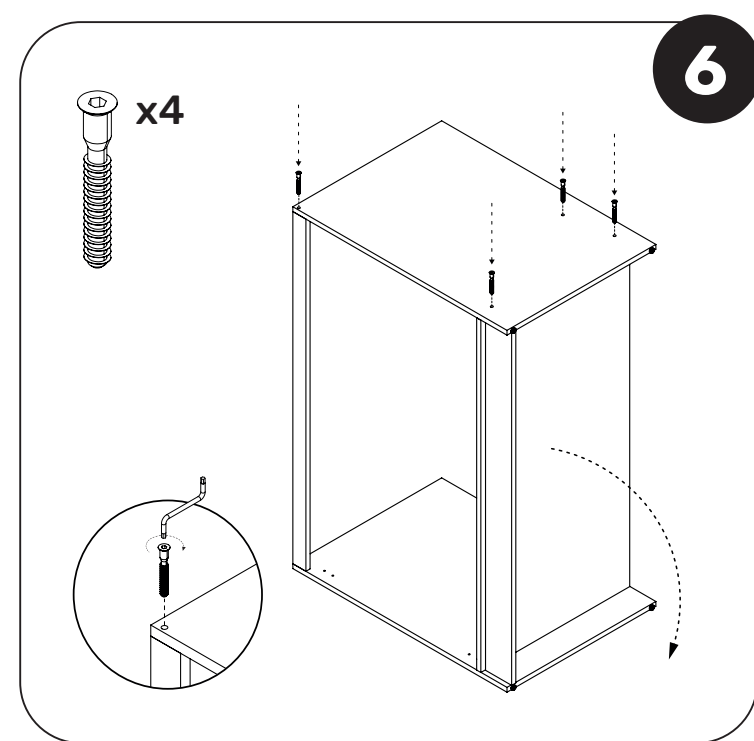
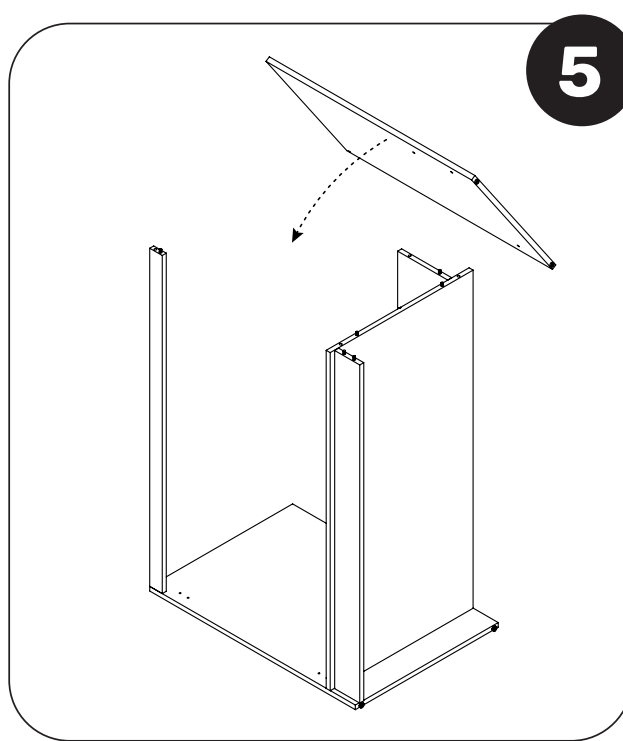
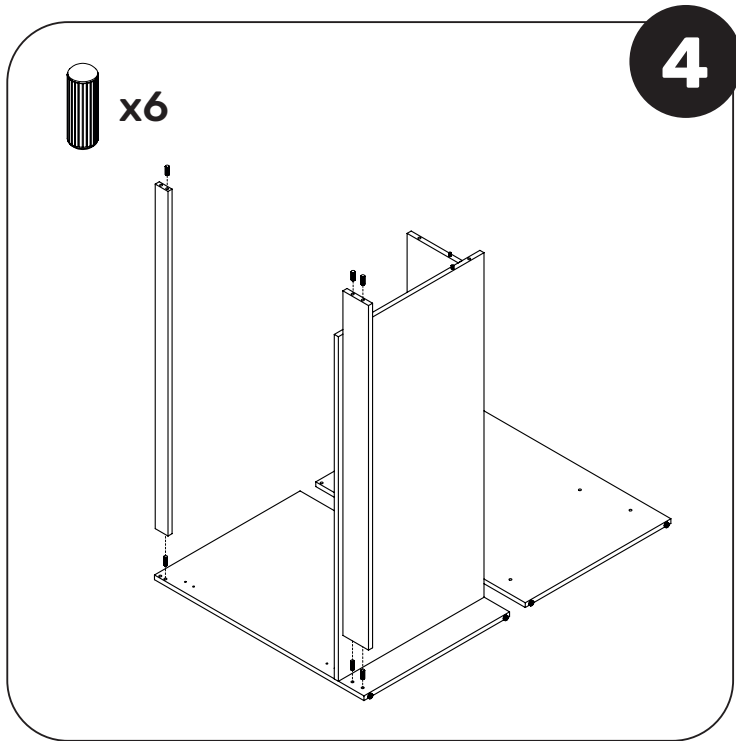

9

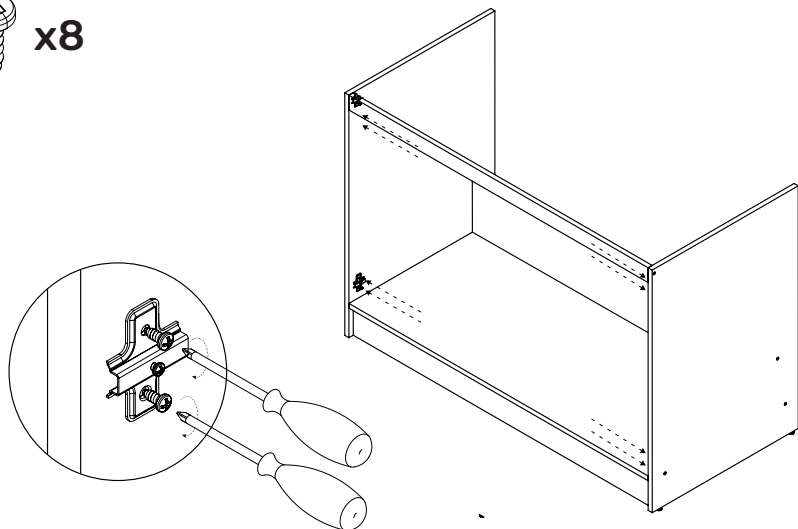

10

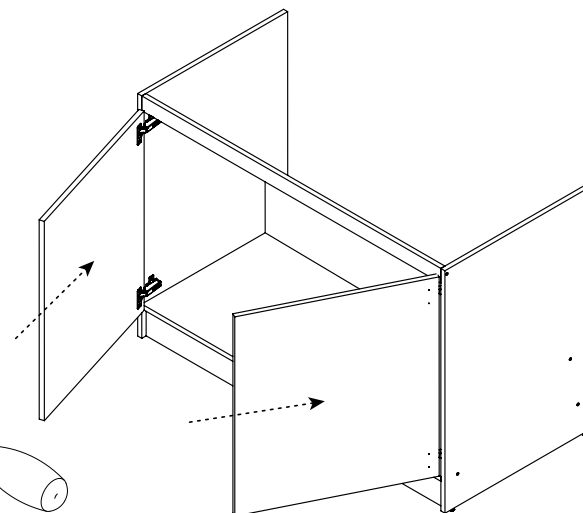
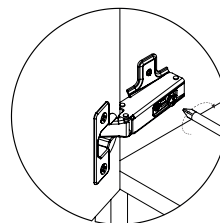
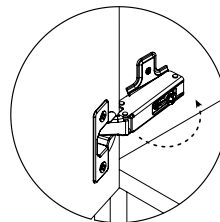

11

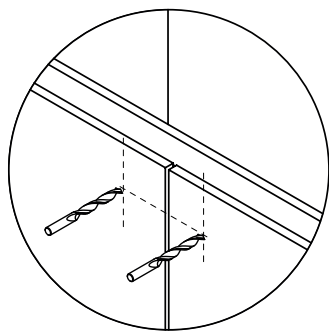

∅ 4 mm

